



Marga Elevator

Design
Solution
Erection
Preparation
Maintenance
Installation
Running
Repair

www.margalift.com

Design by Marga lift : 2021

Marga Elevator





Marga Lift

Hangzhou Margarita Trading Co. Ltd., was established at 2014 to provide quality products in A timely manner, located in the center of national famous tourist city Hangzhou and near to the west lake. The company has been engaged in overall elevator & escalator and their accessories (including guide rail, steel wire rope, elevator light curtain, traction machine elevator safety components, such as driving wheel, chain, etc.) related to import and export business. The major markets involving the Middle East and Europe countries. Over the years, our company has been engaged in the import and export of escalators and their accessories, and has accumulated many foreign customers to understand the needs of foreign markets. Moreover, we have our own website for extern....

We continue to innovate for better elevator solutions

Constantly improved technology and insights into market enable our vertical transportation system increasingly closer to perfection. Every MARG innovation contributes to higher quality elevatorsolutions for modern cities, which combine intelligence, speed, comfort, reliability, safety, spatial aesthetics, energy efficiency and other advantages together.

We are not only committed to helping customers improve the sustainability of commercial value, but also aiming to allow people to enjoy the unparalleled comfort and convenience and to be relieved from journey fatigue in a shorter time and in a more cost-effective way when taking the elevator, and thus creating more benefits and value.

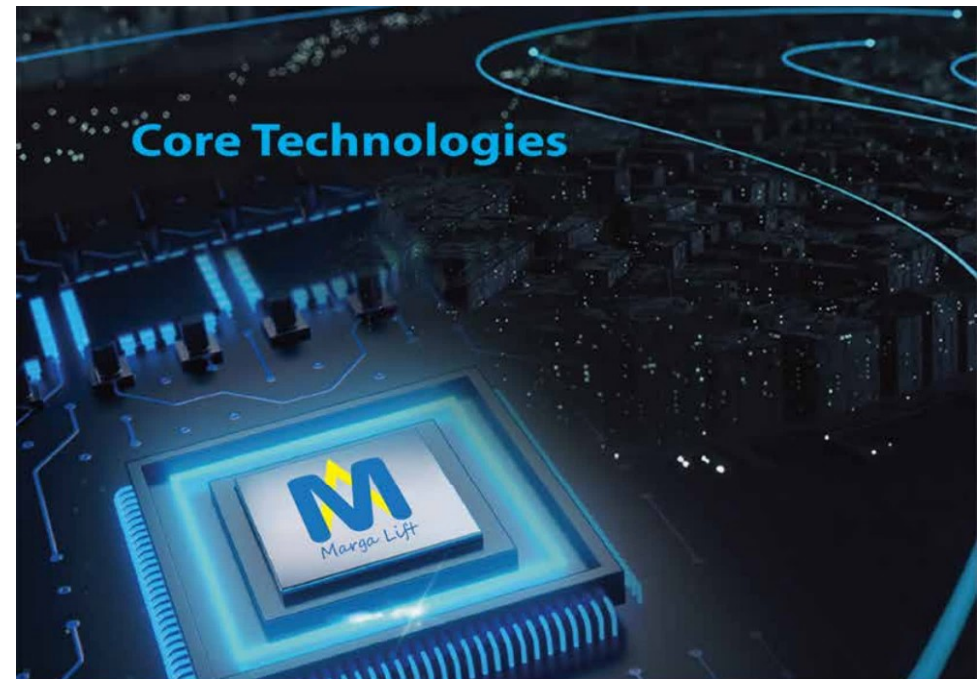

New Generation of Intelligent Vector-based Integrated Elevator Controller

It adopts direct docking technology based on the principle of distance control. The best curve is automatically generated according to the target distance. It supports weighing-free startup technology with various encoders and provides excellent startup effect. With the high-performance vector control technology, it gives full play to motor performance, and thus obtains better comfort.

Gearless Permanently Magnetic Synchronous Tractor

eliminating the use of traditional turbine gear reducer, it greatly improves the transmission efficiency and can save 40% electricity without mechanical wear, vibration and noise caused by reducer gearbox. Without the need for lubrication system, it allows the complete elimination of environmental pollution problems and reduces the maintenance workload. It is small, light in weight, and effective in reducing construction cost.

Sophisticated Door-motor System

It incorporates self-learning function and built-in optimized operation curve that allows simple and easy debugging. Its closed-loop control system enables real-time control over running speed and position, and software-based traditional travel switching. In addition, it is equipped with synchronous belt drive that helps to achieve fewer machinery parts, lighter weight, safer and easier maintenance





Microcomputer Group Control and Management System

It can meet the operational needs of office buildings and other public places during rush hours by adopting the minimum waiting time distribution principle to make the elevator respond reasonably and rapidly. When idle, the elevators are well-distributed in the designated area standby so as to ensure rapid and timely responses to external calls.

Active Controllable Energy Feedback Device

When the elevator is running in an imbalanced manner or stops with checking brake, the frequency converter converts the alternating current (renewable power energy) generated by the mechanical energy into direct current, the energy of which will be sent directly back to the AC power grid through the Active Controllable Energy Feedback Device, so that fast braking and effective energy conservation can be achieved at the same time

The electronic remote butler of configuration

MARGA elevator electronic remote butler is elevator internet of things system with deep integration which forms a technology framework including internet, data acquisition system, cloud server and client. It realized the elevator data managed by the full range of cloud data and online remote monitoring of the running situation in 24 hours.

HIGHLY EFFICIENT AND TOP DESIGN WITH HUMANITY

PASSENGER ELEVATOR-PROFILE PROFESSION CAST THE QUALITY Service Reflect the Value

MARGA elevator adopts advanced intelligent technology in the world, applies exquisite processing technology, producing elevator products with superior quality and perfect system, completely satisfying needs of high-end business building, city complex, hotel, residence, home, shopping stores, city rail transit and so on.

PROFESSION
CAST THE QUALITY



PASSENGER ELEVATOR PROFILE

SMALL MACHINE ROOM

MARGA small machine room passenger elevator main engine adopts permanent magnet synchronous gearless technology, which makes the elevator machine room smaller and improves operation efficiency it has outstanding performance in operating performance, safety function, car design, energy saving and consumption reduction and can be widely used in residential and office buildings and other places

- Significantly save space
- Design flexibility
- Improve installation efficiency



Small machine room

MACHINE ROOMLESS

MARGA machine room less passenger elevator saves the machine room at the top of the building, which brings greater flexibility to the exterior design of the building adopts advanced design concepts and mature control technology to fully demonstrate humanized wisdom. It is suitable for high-rise, small high-rise residential buildings commercial buildings, hotels and other places with high civil engineering requirements

- Save space
- Dynamic comfort
- Widely applicable



Machine room less

Marga elevator



SAFE ACCOMPANYING START A SMART LIFE.

Negative ion cross-flow fan (standard)



The car is equipped with an anion cross-flow fan, which can improve the anion concentration of the air in the car, freshen the air, disinfect and sterilize, eliminate smoke and dust, neutralize high-voltage static electricity, and effectively reduces the harm of high-voltage static electricity to the human body.

Voice reporting station (standard)



Configure the voice station reporting function, that is, the elevator broadcasting before the station will automatically broadcast the arrival floor, reminding passengers to prepare for leaving in time to prevent passengers from taking the bus by mistake.

Voice appeasement (standard)



When the elevator breaks down, the voice appeasement function broadcasts matters needing attention in time to appease passengers' emotions and wait for rescue with peace of mind.

Call function of mobile phone. (optional)



The elevator 4G internet of things system is configured, and the function of calling by mobile phone reservation can be realized through the WeChat applet of "booking elevator assistant", the QR code of elevator and property audit. Achieve contactless ladder riding: Before going out and entering the building, register the call first, so as to reduce the waiting time for taking the elevator.

Intelligent recognition system of car electric vehicle (optional)



In order to prevent electric vehicles from entering the elevator car and causing potential safety hazards, Shenlong Elevator can be equipped with an intelligent identification system for electric vehicles in the elevator car, thus effectively avoiding the risks and potential safety hazards caused by electric vehicles entering the elevator car. According to the different heights of the electric vehicles entering and leaving the car, complete data are collected, and relevant algorithms are matched: after the electric vehicles are identified, the voice warning "No Entry for Electric Vehicles" is given, which is played once every 5 seconds; Close the door with delay, and the delay time can be adjusted (1 minute, 2 minutes, 3 minutes and 5 minutes); After recognizing that the electric vehicle exits, cancel the delay and resume closing.





7100B01

standard

Ventilation: ventilation at the rear or both sides.

Car wall: stainless steel with hairline.

Car door: stainless steel with hairline.

Floor: PVC plastic floor.

Elevator sill: aluminum alloy.



7100B02

optional

Ventilation: air supply in the middle of car roof.

Car wall: mirror surface, etching, hairline.

Car door: stainless steel with hairline.

Floor: PVC plastic floor.

Elevator sill: aluminum alloy.



7100B03

optional

Suspended ceiling: air supply at rear side of car roof.

Car wall: titanium, mirror, etched.

Car: Titanium.

Floor: PVC plastic floor.

Elevator sill: aluminum alloy.



7100B07

optional

Ventilation: air supply at rear side of car roof.

Car wall: mirror surface, etching, hairline.

Car door: stainless steel with hairline.

Floor: PVC plastic floor.

Elevator sill: aluminum alloy.

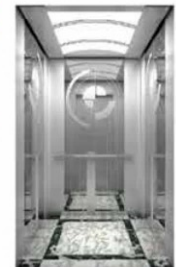



Marga elevator

7100B09

Optional

Ventilation: air supply at rear side of car roof.

Car wall: mirror surface, etching, hairline.

Car door: stainless steel with hairline.

Floor: PVC plastic floor.

Elevator sill: aluminum alloy.



7100B10

Optional

Ventilation: air supply at rear side of car roof.

Car wall: mirror surface and hairline.

Car door: stainless steel with hairline.

Floor: PVC plastic floor.

Elevator sill: aluminum alloy.



7100B12

Optional

Ventilation: air supply at rear side of car roof.

Car wall: mirror surface, etching, hairline.

Car door: stainless steel with hairline.

Floor: PVC plastic floor.

Elevator sill: aluminum alloy.

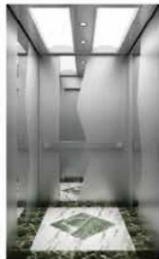

7100B13

Optional

Ventilation: air supply at rear side of car roof.

Car wall: black titanium mirror, hairline stainless steel.

Car door: stainless steel with hairline.

Floor: PVC plastic floor.

Elevator sill: aluminum alloy.

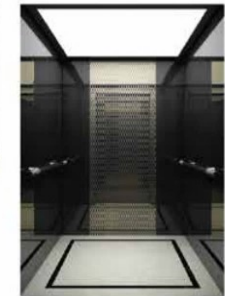

7100C04 Optional

Ventilation: rear side.

Car wall: Three side car walls are made of mirror stainless steel with gold sandblasting in the middle and gold sandblasting in both sides, and the bottom sandblasting stainless steel skirting line.

Ceiling: Champagne gold

sandblasting frame around it is illuminated by downlights, and acrylic transparent board in the middle is illuminated by stainless steel decorative strips.

Handrails: metal circular handrails on the rear side.

Car door: champagne gold wire drawing etching.

Door: champagne gold wire drawing etching.

Floor: parquet marble

Elevator sill: aluminum alloy.

7100C05 Optional

Ventilation: rear side.

Car wall: black titanium mirror etched in the middle of the rear wall, black titanium mirror stainless steel on both sides, black titanium mirror stainless steel on the side wall and black titanium hairline stainless steel skirting line on the bottom.

Ceiling: Soft-mounted transparent illuminating black titanium mirror stainless steel frame.

Handrails: round handrails on both sides (leather finishing in the middle and metal decoration at both ends).

Car door: black titanium mirror etching.

Door: mirror etching in champagne gold.

Floor: parquet marble

Elevator sill: aluminum alloy.





Marga elevator

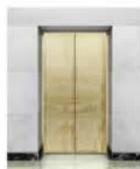

7100C011 Optional

Ceiling: steel plate spraying, middle spray printing version.

Car wall: art glass, champagne gold decorative frame, hard package decoration.

Handrails: champagne blonde.

Car door: champagne gold mirror.

Door: mirror etching in champagne gold.

Floor: PVC

7100C012 Optional

Ceiling: mirror stainless steel, decorated with simple lamps.

Car wall: Dali stone, mirror stainless steel leather hard package.

Handrails: leather hard wrapped flat handrails.

Car door: mirror stainless steel.

Door: mirror etching in rose gold.

Floor: PVC



7100C01 Optional

Ventilation: rear side.

Car wall: wood veneer on both sides of titanium car border in the middle of the rear wall, wood veneer on both sides of leather veneer in the middle of the side wall, with metal lines.

Ceiling: wood-faced oil-gold paint frame with middle gold foil finish, and middle chandelier with simple lamp lighting.

Handrails: round wooden handrails on both sides (metal decoration at both ends).

Car door: mirror etching in rose gold.

Door: mirror etching in rose gold.



7100C03 Optional

Ventilation: rear side.

Car wall: The three sides of the car wall are made of middle art glass, and the two sides are made of titanium mirror stainless steel with embedded metal decorative strips.

Ceiling: Titanium mirror stainless steel on both sides of sandblasting finish in the middle, LED indirect lighting supplemented by downlight lighting.

Handrails: round wooden handrails on both sides (two titanium mirror surfaces).

Car door: Titanium mirror etching.

Door: mirror etching in champagne gold.

Floor: parquet marble

Elevator sill: aluminum alloy.



7100C06 Optional

Ventilation: rear side.

Car wall: Rose gold mirror on both sides is etched in the middle of rear wall, and rose gold mirror on both sides of stainless steel mirror on the middle of side wall is decorated with metal strips.

Suspended ceiling: Rose gold sandblasting frame, lamp belt lighting.

Handrails: round handrails on three sides (rose gold mirror surfaces on both sides of middle metal paint).

Car door: mirror etching in rose gold.

Door: mirror etching in champagne gold.

Floor: parquet marble



7100C13 Optional

Ceiling: steel plate spraying and downlight decoration.
Car wall: laminated glass, mirror stainless steel, wood veneer.

Handrails: stainless steel flat handrails.

Car door: champagne gold mirror.

Door: mirror etching in rose gold.

Floor: PVC

Elevator sill: aluminum alloy.



7100C07 Optional

Ventilation: rear side.

Car wall: mirror stainless steel on both sides of the middle plate of the rear wall, the rest (including the middle plate of the rear side), baking varnish on metal plate (matte champagne gold paint) (horizontal stripe), and mirror stainless steel skirting line at the bottom.

Ceiling: metal plate painted (dumb champagne gold paint) frame, white acrylic transparent board supplemented by stainless steel decorative strip.

Handrails: transparent acrylic flat handrails on the rear side.

Car door: mirror etching.

Layer: mirror etching.

Floor: parquet marble

levator sill: aluminum alloy.



7100C10 Optional

Ventilation: rear side.

Car wall: laminated glass in the middle of the rear wall, clear glass on the front side of the side wall, and mirror stainless steel on the rest.

Ceiling: white painted frame, acrylic lamp lighting and metal strip decoration.

Handrails: transparent acrylic round handrails on the back side.

Car door: mirror etching in natural color.

Door: mirror etching in natural color.

Floor: parquet marble

Elevator sill: aluminum alloy.



Marga elevator



Intensive specialist of the space independent well space needs no machine room Without restriction of machine room,

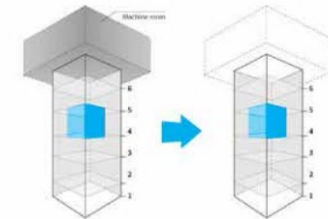

Without restriction of machine room, you get more than what you imagine

After redecoration the original machine room space can be a small warehouse or a small hanging garden.

it only needs to preset the well space, it is freer in designing the building space. It thus greatly reduces the pressure of the architectural engineers.

Multiple panorama fails of vision satisfy more and more of your requirements

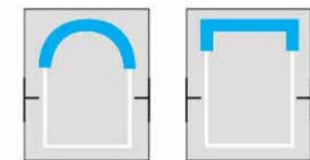

Semi-circular

Square shaped

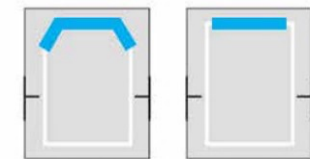

Cutting-angle-type

Future prospects

Light and handy appearance: Adopt no machine room structure place control cabinet and tractor flexibly in well, which can take advantage freely of precise construction space.

Operation with low noise: Gearless machine for driving with no vibration, noise, creating tranquil Ride environment

Energy saving and environmental friendly: Adopt multiple energy conservation technologies and devices, with energy conservation reaching 60%



XLCO-17 Optional

Upper / lower hood: Round corner-cut steelplate backed enamel, acrylic light-emitting

Panorama wall: Round laminated safety glass (3pcs)

Ceiling: Painting steel panel, acrylic

Car wall: Hairline stainless steel

Car door: Hairline stainless steel

Handrail: Stainless steel tube

Floor: PVC floor.

XLCO-18 Optional

Upper / lower hood: Creamy white acrylic

Upper/ lower still: Steel plate D model, downlight

Panorama wall: Round laminated safety glass (3pcs)

Ceiling: Painting steel panel top panel, central round creamy white acrylic lighting decoration, acrylic crystal lamp decoration in the latter part

Car wall: Hairline stainless steel

Car door: Hairline stainless steel

Handrail: Stainless steel tube

Floor: PVC floor.



Marga elevator



ELEVATOR SILL ALUMINUM ALLOY



GX901 Optional

Upper and lower covers: steel plate paint, acrylic light bar.

Car top: SLD0702, steel plate baking varnish, acrylic arch indirect lighting, supplemented by downlight soft lighting.

Sightseeing wall: safety laminated glass (-block).

Ventilation: supply air on both sides of the car roof (fan plus deflector).

Car wall and car door: stainless steel with hair pattern (optional etching, stainless steel with hair pattern and mirror surface).

Floor: PVC plastic floor.

Elevator sill: aluminum alloy.

GX1103 Optional

Upper and lower covers: painted with steel plate and decorated with milky acrylic.

Car top: steel plate painted frame, acrylic top plate.

Sightseeing wall: safety laminated glass, where the glass splicing is at right angles.

Ventilation: supply air on both sides of the car roof (fan plus deflector).

Car door: hairline stainless steel frame, safety laminated glass.

Floor: PVC plastic floor.

Elevator sill: aluminum alloy.





GX1102Optional

Upper and lower covers: steel plate paint frame, acrylic lighting.

Car top: steel plate painted frame, acrylic top plate.

Sightseeing wall: safety laminated glass (three pieces).

Ventilation: supply air on both sides of the car roof (fan plus deflector).

Car wall and car door: stainless steel frame with hair pattern (optional etching, stainless steel with hair pattern and mirror stainless steel).

Floor: PVC plastic floor.

Elevator sill: aluminum alloy.

GX1104 Optional

Upper and lower covers: steel plate paint, acrylic lighting.

Car top: steel plate paint spraying, medium acrylic top plate.

Sightseeing wall: safety laminated glass.

Ventilation: supply air on both sides of the car roof (fan plus deflector).

Car door: hairline stainless steel frame, safety laminated glass.

Floor: PVC plastic floor.

Elevator sill: aluminum alloy.



Marga elevator



COP & LOP STANDARD

ML1101

Integrated structure with front wall
(width not less than 177mm).
Fawen stainless steel
Lattice display
Built-in intercom telephone
LED emergency lighting
Square blue button with Braille.



Picture machine



Segment code display



ML1101
Outbound



ML1101
Embedded option

ML1101
Embedded option

Marga elevator



COP & LOP OPTIONAL

ML2102C

Hairline stainless steel
Lattice display
Built-in intercom telephone



ML2102C
embedded



ML2102L
wall mounted



ML2103C
embedded



ML1901
wall mounted



ML2101C

Black glass panel.
Picture display (call dot matrix display)
Built-in intercom telephone
Emergency lighting

ML2101C

White glass panel
Picture display (call dot matrix display)
Built-in intercom telephone
Emergency lighting



ML2101C
(black)
embedded



ML2101H

ML2101L
(black)
embedded



ML2101C
(white)
embedded



ML2101H

ML2101L
(white)
embedded



ML2102L-wall
hanging(optional)



ML2102LB-wall
hanging(Union)



ML2102LC
wall hanging



ML2102F
wall hanging



Marga elevator



Business, simplicity, modernity and classic.
Concise, delicate and calm.



ML 1501



ML 1502
ML1501- Wall hanging(optional)
ML1502- Wall hanging(union)



ML 1501



ML 1502
ML1501- Wall hanging(standard)
ML4502- Wall hanging(union)

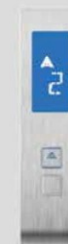

ML 1501



ML 1502
ML1501- Wall hanging type
ML1502- Wall hanging type



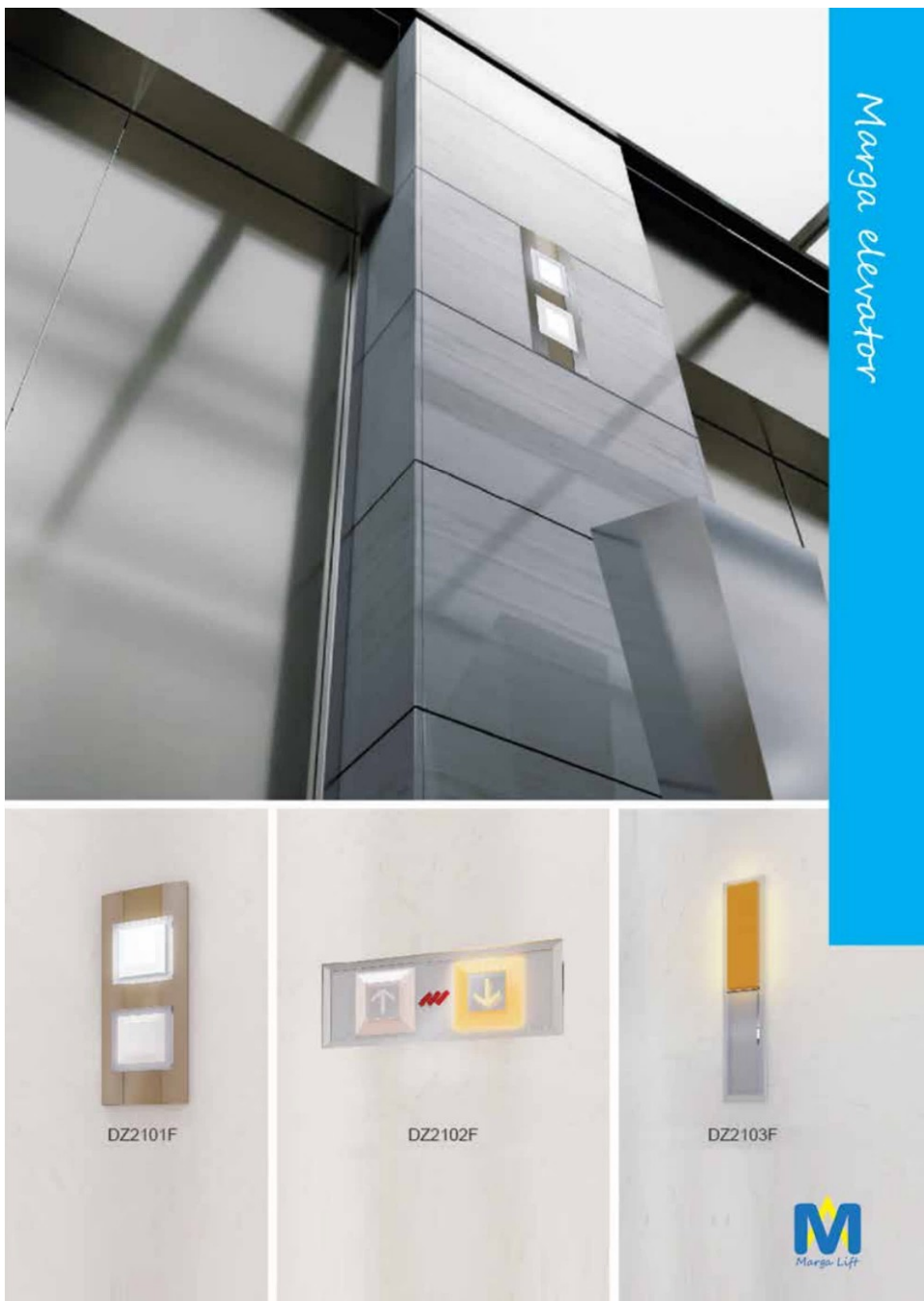

ELEVATOR CAR CEILING

MLD0702 Option

Mirror stainless steel
Acrylic arch
Soft lighting assisted by
downlights.



MLD1301 Option

Mirror stainless steel
Acrylic transparent board
illumination
With downlight lighting



MLD0202 Option

Mirror stainless steel
Arched organic transpar
plate and downlight.



MLD0703 Optional

Soft lighting of wide arched white transparent plate.

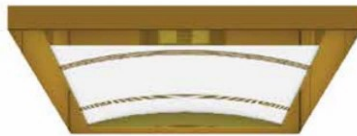

MLD1302 Optional

Spray bright black paint on steel plate.
Assisted by acrylic transparent board lighting.



MLD0301 Optional

Mirror stainless steel
Arched aluminum plate
indirect lighting simplified lamp.
Applicable to car depth not more than 1600 mm.



HALL DOOR



MLT-001



MLT-003



MLT-006



MLT-007

COLOR DOOR



RAL1015



RAL7035



RAL7032



RAL9010



HANDRAIL



MLF-001



MLF-002



MLF-003



MLF-004

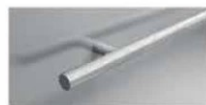

MLF-005



MLF-006

FLOOR



MLP-091



MLP-092



MLP-001



MLP-002



MLP-003



MLGP-001

Marga elevator



CLASSIC DECORATION SERIES

Door Jamb



Narrow door jamb



Wide door jamb



MN-T016



G001



G002



Hall Door Series



Center opening



Side opening



Double-folded center opening type



3-folded center opening type side opening



MN-T013



MN-T014



MN-TM015



Marga elevator



STRUCTURE



OPTIONAL SMALL MACHINEROOM
ELEVATOR OR MACHINEROOM_LESS
ELEVATOR

MODULAR STEEL STRUCTURE

BLOCKS TYPE QUICK
INSTALLATION STRUCTURE

BLOCKS TYPE QUICK
INSTALLATION STRUCTURE

IT DOES NOT AFFECT THE LIGHT -
CATCHING

LOW CONSTRUCTION NOISE

Small machine room elevator applies compact small machine room layout. It effectively reduces top floor space. It cuts down the building cost to maximum extent. Machine room-less elevator breaks through a must of machine room. It thus greatly reduces the building area. It enhances the design freedom. It provides limitless space in modern building with infinitely creativity.

It utilizes standard steel material. It applies unique design, craft & technology for making. Steel structure well has been designed and manufactured by professional team. It can adapt to various complicated building structures. It perfectly combines with the elevator equipment.

Main body of Marga Ruyi elevator frame and elevator equipment go through modular integrated machining & forming in the manufacture factory. It only needs overall installation, debugging, operation at site. It can be as quickly as 5 days to finish the installation. It is prompt and convenient with high safety coefficient.

It only requires 800mm of minimum pit depth. Minimum well size can reach 2100mmx1800mm. It utilizes the space to maximum extent.

According to original space design in the residential quarter, it adjusts measures to local conditions. It designs different connection and entry modes. It saves space, meets the requirements of light-catching, ventilation etc.

Extremely low noise in construction is lower than 50decibel. It does not disturb the people with zero complaint. While it is thrown into use, elevator runs peacefully with low noise. It does not harm the rest of the owners and residents.



Machine roomless wells

Marga elevator



NEXT LEVEL
INNOVATION

MAX
maintenance



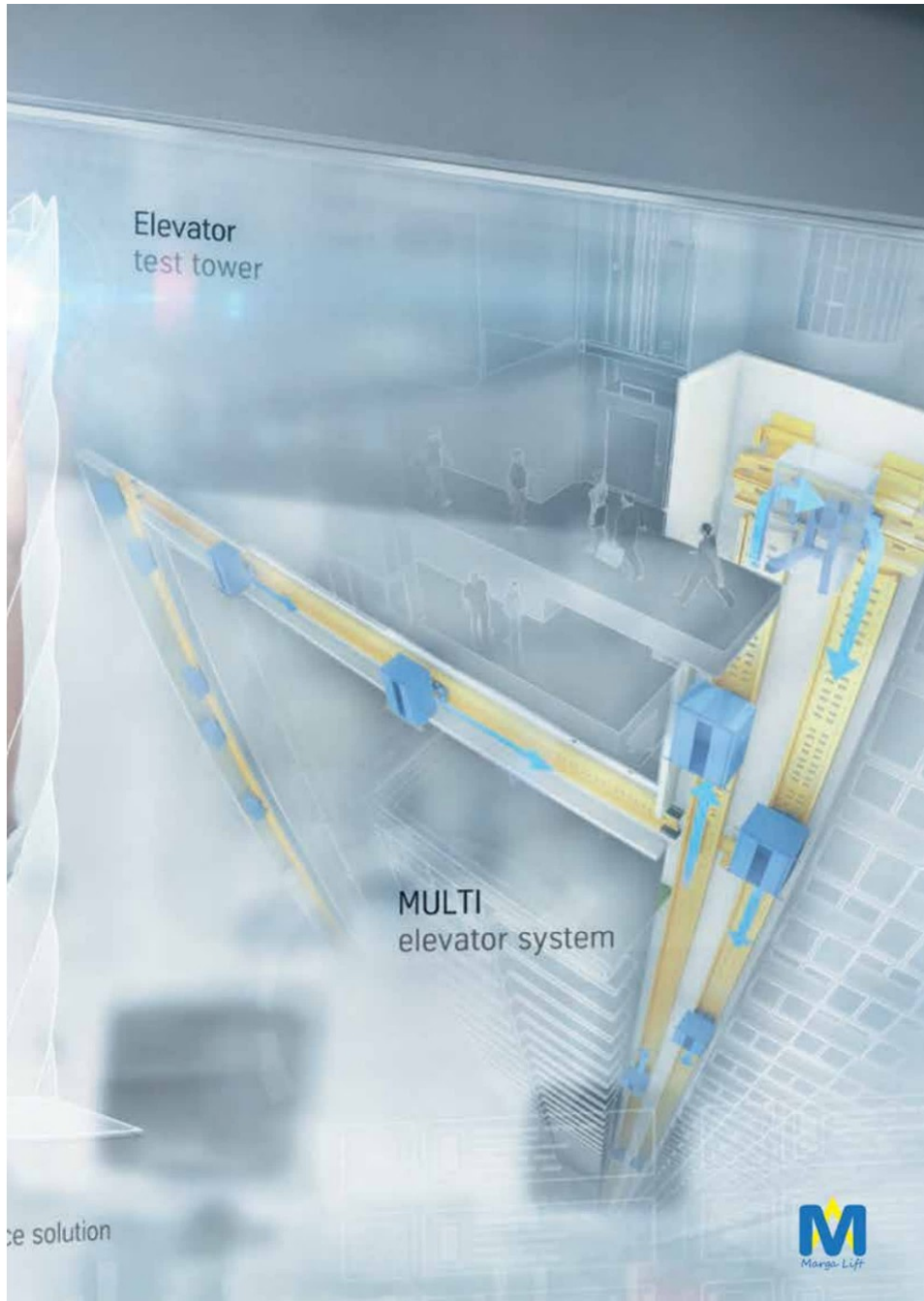

455 mm

435 mm

Upper Beam

Elevator Air Conditioner

613 mm

Car Door System

Remote Control Probe

Return Air Cap

Heat Insulation Flex Du

Cool Air Out Cover

Elevator Car

395 mm

60 mm

Diameter: 150mm

135 mm

TK-AC System with Advance De-humidification Technique

to make your elevator experience comfortable in hot, humid and cold environments, marga brings an air Conditioning system specially designed for your elevator. the product is designed considering limited space on top of elevator car, the humidification effect, noise and vibration.

Marga Lift



41.3% of Tested Power Saving Rate and 28%
of actual Power Saving Rate

Gearless
synchronous Motor



Gearbox
asynchronous Motor



Save space by 60%

The area occupied by the MR Gearless small machine room electric elevator is equal to the cross sectional area of the shaft, which is 60% less than the area occupied by the MR Gearbox- machine room elevator.

Note:

- (1) The above data applies to elevators with a deadweight of 1050kg.
- (2) If the Gearbox is placed in the machine room, the area of the machine room will be larger than the area of the cross section of the merged lane.

High Efficiency and low consumption

permanent magnet synchronous gearless traction machine.

Pioneer technology:

The brand new concept of the MARGA permanent magnet synchronous gearless traction system eliminates the rotor coil required by traditional asynchronous motors.

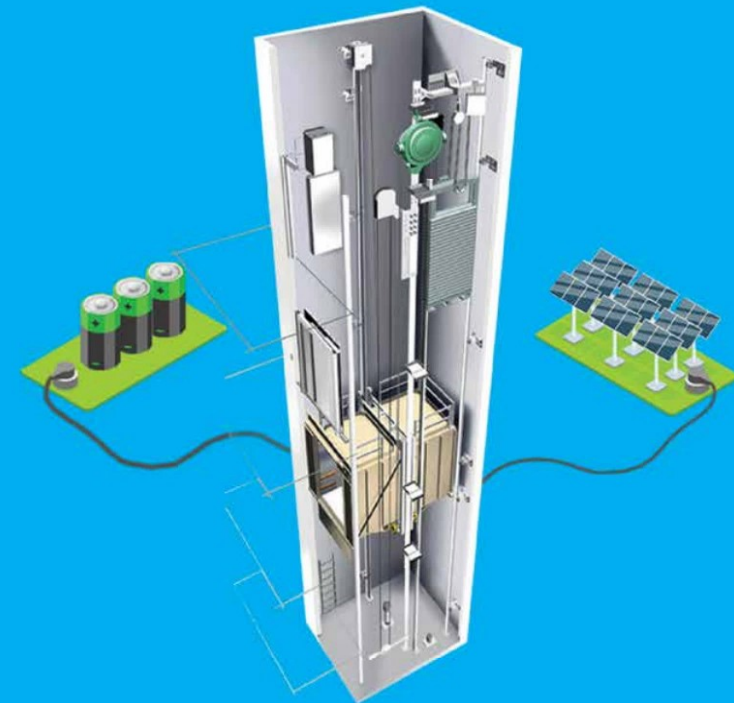

GREEN MOTION



GREEN MOTION WORKING PRINCIPLE

Green Motion Option (200 push button up & down) Green Motion Working Principle Green Motion Intelligent Elevator Energy Management consists of SQML Gearless Elevator or Motor Elevator driver, 320 V, 7 Ah battery pack and an intelligent Green Motion card. This card and the elevator driver are connected to the 220 VAC single-phase network. The battery pack is connected to the DC bus of the drive via the intelligent floor. In this way, our motor works even if there is no mains voltage.

- 1- Can an elevator move 200 times in the event of a power failure.
- 2-Is it possible to save more than 70% energy.
- 3- 230 V and up to 1250 kg carrying capacity single phase input option



PASSENGER ELEVATOR

Enjoy life beyond imagination

PROFESSION CAST THE QUALITY
Service Reflect the Value

MARGA passenger elevator masters high speed heating technology of elevator with intelligent safety, worship for consistency, which is widely used in hotels, restaurants, office buildings, residence buildings, entertainment and large scaled shopping malls providing superior quality for travel.

SIGHTSEEING ELEVATOR

City scenery viewing the world

MARGA sightseeing elevator and city building are totally natural, allow you to view the world from up and down, which is widely applied in large scaled buildings like hotels residence building and office buildings and so on.



Marga elevator



VILLA ELEVATOR

Private and luxurious space for life with superior quality

MARGA Home elevator is customized according to individualized aesthetics, creating different f beautifying space and at the meantime improves greatly family le quality



HOSPITAL ELEVATOR

Humanistic care healthy space

MARGA sightseeing elevator and city building are totally natural, allow you to view the world from up and down, which is widely applied in large scaled buildings like hotels residence building and office buildings and so on.



FREIGHT ELEVATOR

Undertake important responsibility, successful accomplishment of mission

MARGA elevator realizes super expanded lift car design, ensuring safe and stable operation of large scaled goods, which is widely applied in factory warehouse Shopping mall and library.



CAR ELEVATOR

Enjoyed with intelligent safety

MARGA car elevator makes unique design in aspects of appearance safety performance, humanistic application and so on based on special properties of car products, with mature application of car lifting technology creating intelligent, safe, and convenient man-car space



Marga elevator



DUMBWAITER ELEVATOR

Marga Dumbwaiter has reliable performance and is easy to be installed. With the compact design, it takes less space and has lower requirements in construction support base. Besides, no construction shaft is required, only to leave a hole at the installation position, which enables the design and layout of building to be easier. And the door open direction and method is various, which can meet all kinds of requirements.

Specification Lift cabin: Hairline stainless steel, a shelf in the cabin for window type dumbwaiter.

Landing door: Hairline stainless steel, • 1: 2T.

Door jamb: Hairline stainless steel.

Door slide: Special material of aluminum alloy.

Call box: Stainless steel, push button, LED digital display, indication of door close/open, arrival buzz



CAR PARKING SYSTEM

**As well as providing market-leading lifts,
we are specializes in pioneering Car**

Parking Systems solutions, Our Parking Systems fulfill the most stringent urban planning specifications, ensuring optimum utilization of space, cost efficiency and quick installation.

Offer a diverse range of vertical stacking and sliding platform solutions. Building on technological advancements, our intelligent multi-storey Parking Systems guarantee exceptional performance, passenger comfort and safety



Puzzle Car Parking System



Stack Parking System



Hydraulic Car Parking System



Tower Car Parking System



Vertical Car Parking System



Two Stack Car Parking System

Marga elevator

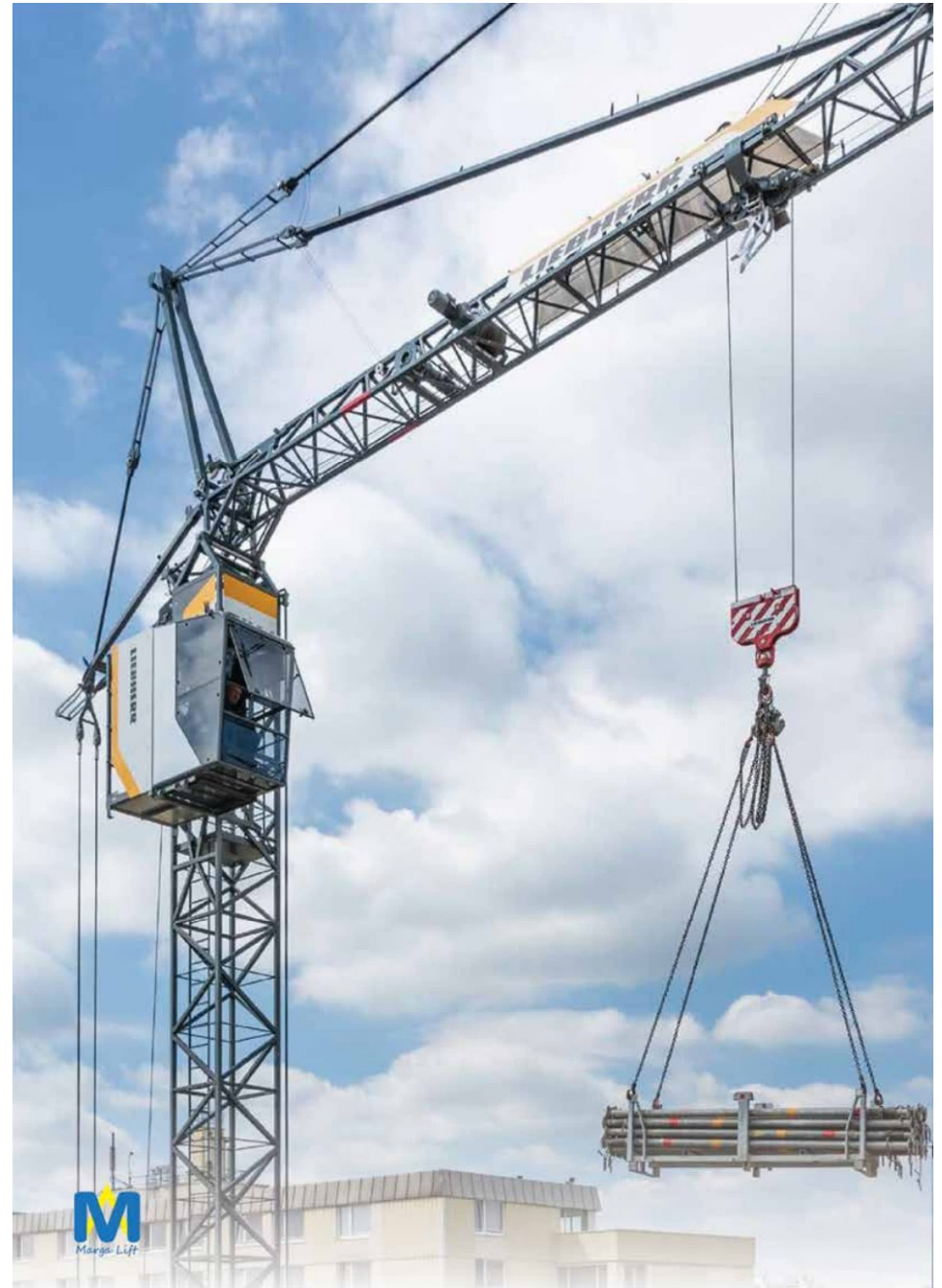



TOWER CRANE

The first K series crane was delivered in 1961. Since then the world of construction has changed drastically but the basic idea of the fast-erecting crane has remained. Your construction sites require special flexibility, high lifting capacities and a crane which requires little maintenance and can also be transported and erected quickly and easily. ...with a modern interpretation. Ever since they were launched, Marga K cranes have provided you with the perfect solution for your hoisting work – from single houses to large industrial projects.

Equipped with modern driving units and an intelligent control system with a wide range of assistance systems, the current K series is still based on the time-tested principle of the fast-erecting crane. Their smart erection process and lots of different ways of adjusting the hook height and jib length make them easy to use. And thanks to their improved external dimensions, they will fit in almost any gap.

Marga elevator



Standard function		
no.	function	description
1	Total collective choice	In automatic running or attendant state, this function enables elevator to respond both car calls and hall calls of same directions. Passengers at any service floor can call the elevator by pressing the up call button and down call button.
2	Attendant Operation	When the elevator is operated by an attendant, it will not close the door automatically. When there is outer call registration, the buzzer will sound to remind the attendant that someone is calling the elevator. After the attendant presses the closed button, the elevator will close the door and work.
3	Attendant Orientation	When the elevator operated by an attendant, and when the driver closes the door, he/she can select the way to change the original moving direction of the elevator to make the elevator move under the attendant intention.
4	Attendant's special function (driver & straight driving)	If the attendant operation and straight driving switches are active synchronously, the elevator will move depending on car instructions.
5	Fire evacuation operation	After receiving a fire emergency signal, the elevator does not respond to any call but directly runs to the fire emergency floor and waits.
6	'Up', 'Down' door opening	When an elevator is under inspection, the 'up', 'down' signals will not be registered. Instead, the 'up' and 'down' buttons within the top of the car can be operated to control the movement of the elevator.
7	Door opening and closing during inspection time	During the inspection process, if the 'up' and 'down' buttons are pressed simultaneously, and the elevator is within the 'door frame range' on certain floor, the system will emit signals to force the door open. Door closing and opening buttons would not take effect during inspection time.
8	Low-speed self-rescue operation	When the elevator is in non-inspection state and stops at non-leveling area, the elevator automatically runs to the leveling area at low speed once the safety requirements are met, and then opens the door.
9	Automatic door opening after arriving	When the car arrives at its location and is lined up to the destination floor, the door will be opened automatically.
10	Automatic door closing delay	When there is no attendant operating, and the elevator arrives at its location and opens its door, the door will be kept open for a corresponding time delay period, and then shut again.
11	Out hall door opening	The car door opens automatically if calling button in this floor is pressed. And the elevator will not close until the button is released.
12	Door pre-close by the door close button	After door opens completely in automatic running state, the door will be closed immediately after pressing door closing button.
13	Opening the door by using the door opening button	When the elevator is stopped within the 'door frame range' the 'open door' button can be used to open the door again.

Marga Elevator Functions

Standard function		
no.	function	description
14	Repeat door close	If the door lock is not applied after the elevator performs door close for a certain time, the elevator automatically opens the door and then closes the door again. As if the door does not close completely at the fifth time, then open the door and wait for repair.
15	Car arrival bell	After the elevator arrives at the destination floor, the SSL-7020 gives a prompt tone.
16	Auto energy saving operation with illumination and ventilation	When the elevator has been spared over a certain time. The system will automatically cut off power of the illumination and ventilation fan in the car. However, all these functions will be re-employed as soon as someone presses any in-hall calling comes up, the elevator will respond instantly.
17	Auto returning to the base station	In automatic running state, the elevator automatically returns to the base station and waits for passengers if there is no car call or hall call within the set time. When there is an instruction or calling, the elevator will response immediately.
18	Operation frequency and duration record	It can actual record actual operating time and hours of elevators.
19	Elevator lock-down & inspection status display	When elevators are under maintenance or are locked down from service, and the calling buttons in the halls are pressed requesting far service, the display board will show STOP or PARK to indicate the current status of the elevators and give out information on the location of the elevators.
20	Elevator lock service	In automatic running state, when the elevator lock switch reaches stop position, the elevator cancels all registered calls, returns to the elevator lock floor, stops running, and turns off the lamp and fan in the car; reaches running position, the elevator starts working.
21	Light curtain protection	In order to improve security protection the process of closing, the system provides judges curtains enable select. If the door is blocked by stuff during door close, the light curtain acts and the elevator opens the door. This function is invalid in fire emergency state.
22	Overload protection	When the car load exceeds the rated elevator load, the elevator alarms and stops running, on when the point lower than the maximum loading threshold, the elevator will return to its normal operation.
23	Converse movement protection	Whenever the system inspects a converse movement of an elevator as contradicting to the signaling direction that lasts more than 3 seconds. The elevator will stop all of its operations. And the fault alarm will be sounded, until the problem is fixed or the control panel is recharged again.
24	Protection from rope slippage	When the system inspects a slipping slope, the elevator will stop all of its operations immediately, and the fault alarm will be sounded, until the problem is fixed or the control panel is recharged again.
25	Protection of anti-slipping of terminal program	Every elevator is installed with limit switches on its upper and lower terminal landing. When elevators lose control in deceleration, the slow down switch will be forced to open, and the elevator will be obstructed to decelerate and stop. But if the elevator continues to traveling, the terminal landing switches start to work, the main circuit and the control circuit will be power off and the elevator will stop immediately.
26	Door locker jumper protection	When the elevator arrives at its location, if the system inspects that the door locking contactor is switched on, the fault alarm will sound, and the high-speed operation will be cancelled until the maintenance procedures are finished or the controller is recharged.

Standard function		
no.	function	description
27	Timing device fault protection	When system inspects fault signals with the timing device, the elevator will stop working and the fault alarm will sound, the high-speed operation will be cancelled until the maintenance procedures are finished or the controller is recharged.
28	Cancellation of wrong calls	This function refers to the cancellation of a falsely registered order/calling, this can be done through continuously pressing the button twice.
29	Frequency inverter driver	Precisely adjust the rotation speed of the door motor so that the elevator can have a smooth speed curve, when it startup operating, stopping processes and the passengers can feel comfortable.
30	Door operator inverter driver	Precisely adjust the rotate speed of the motor so that the gate would open and close smoothly and swiftly.
31	Emergency lighting	During a power off period, the illumination in the car will be lightened automatically
32	Motor over heat protection	Motor is equipped with temperature sensor element. Once the elevator is overheated the elevator will stop.
33	Door open time setting	The system automatically determines different door open time for door open for call, command, protection, or delay according to the set door open holding time.
34	Response at acceleration	The system allows the elevator to automatically respond to calls from the service floors during acceleration.
35	Landing at another floor	If the door open time exceeds the door open protection time and the door open limit signal is still inactive, the elevator closes the door and then automatically runs to the next landing floor. The system reports fault ESS.
36	Periodic self-check in standby state	The systems perform self-check on the elevator periodically and records error information within the set time, ensuring reliability and security of elevator running.
37	Automatic startup torque compensation	The system automatically implements startup torque compensation based on the current car load, achieving smooth startup and improving the riding comfort.
38	Direct parking	The system automatically calculates and generates the running curves based on the distance, enabling the elevator to directly stop at the leveling position without creeping.
39	Automatic generation of optimum curve	The system automatically calculates the optimum speed curve compliant with the human-machine function principle based on the distance, without being limited by the number of curves or short floor.

Marga Elevator Functions

Standard function		
no.	function	description
40	Service suspension output function	When the elevator cannot respond to hall calls,the corresponding terminal outputs the service suspension signal.
41	Elevator abnormality protection	The system has the powerful elevator abnormality protection, it can analysis and process the abnormality timely,thereby improve the security of elevator.
42	Inertia identification	The system automatically identifies the elevator inertia at startup and produces compensation,achieving smooth running.
43	Runaway prevention	The system detects the running state of the elevator in real time.If the elevator speed exceeds the limit, the system immediately stops running of the elevator.
44	Passenger unloading first upon fault	The system automatically classes the fault levels.If the safety running conditions are met,the elevator first runs to the leveling position to unload passengers.
45	Energy-saving of idle door machine	After the car lamp is turned off,the system does not output the door close command,which reduces power consumption of the door operator.
46	Full-load direct running	When the car is full-loaded in automatic/attendant running state,the elevator does not respond to hall calls from the passing floors. It only responses to the signals emitted from within the elevator.
47	Full-load indication	When the elevator is full-loaded, the condition will be displayed on the out call board and the elevator runs directly to the determined floors of inner call.
48	Micro-leveling	After landing at a floor,the elevator may move upward or downward due to the load change and the car door is not aligned with the ground,which is inconvenient for in and out of passengers and goods.In this case,the system allows the elevator to run to the leveling position in the door open state at the leveling speed.
49	The by-pass detection function	In order to preserve the contact of the hall door and the car door (including the door locks contact), add a by-pass device to the control cabinet, when the by-pass is triggered, the elevator can only maintenance operation or repair the emergency electric operation, and the elevator will be a flashing signal and alerting.
50	The car accident mobile protection device	In the layer of hall door and the car door open, the elevator can prevent the moving due to the failure of any single original of the driving host or driver control system that the elevator car is dependent on for the safe operation of the cage.
51	The door lock short-connect detection function	Each elevator door can be locked quickly for a quick check. If the car door or the hall door is short-connected, the elevator report fails and unable to operate.
52	Door pre-open	During automatic running state, when the elevator speed is under 0.2 m/s and the door zone signal is active, the system short connects the door lock by door sealing contactor and outputs the door open signal, implementing door pre-open.This improves the elevator use efficiency.

optimal function		
no.	function	description
1	Power failure emergency rescue	For the elevator configured with UPS,the system uses the UPS to implement low-speed self-rescue in the case of power failure.
2	Running direction self-identification at power failure	When the power supply is interrupted,the system can automatically identify the current car load and determine the running direction.
3	Firefight operation	After the elevator enters the firefighter operation mode,door opening/closing are operated by buttons instead of itself. In addition,the elevator responds to only car calls and only one call can be registered once.
4	Anti-disturbance function	The system automatically determine the number of passengers and registered calling in the car,if the registered callings in the car are too many, the system considered it disturbance state, and then it cancels all registered callings from the car. The passengers need to register correct instructions again.
5	Independent running	The elevator does not respond to any out call,and the door needs to be closed manually.In the case of group control the elevator runs independently out of the group control system.
6	Parallel running	The system supports parallel control of two to eight elevators and provides multiple scheduling algorithms to meet requirements of different customers.
7	Dispersed waiting	In parallel/group control,the elevators can wait at different floors.
8	Interface for intelligent residential management (Interface of BA)	The system allows the elevator to automatically respond to calls from the service floors during acceleration.
9	Remote call for help	card should be configured within the communication module) can be connected to mobile or telephone(Maintenance, property, etc. and up to 5 phone numbers) while matching with the electronic remote steward (2G); be connected to private the computer while matching with the electronic remote steward (Ethernet / 3G).
10	Electronic remote butler (Ethernet)	Elevator data collection, Video acquisition, Voice intercom and Ethernet wireless communication(Module: be connected wired internet) can be realized. Local equipment data(as elevator running condition date) and video information be transferred to specified server of elevator internet of Things by wireless network; Meanwhile, remote voice intercom can be realized by connecting IOT-TIM2 module of electronic remote butler to elevator intercom system. User can manage condition monitoring and fault analysis by visiting WEB server.
11	Electronic remote steward (3G)	Elevator data collection, Video acquisition, Voice intercom and 3G wireless communication(SIM card be put in module) can be realized. Local equipment data (as elevator running condition date) and video information be transferred to specified server of elevator internet of Things by wireless network; Meanwhile, remote voice intercom can be realized by connecting IOT-TIM2 module of electronic remote butler to elevator intercom system. User can manage condition monitoring and fault analysis by visiting WEB server.
12	Electronic remote steward(media operation)	Besides electronic remote butler(Ethernet/3G), media operation also combines advertising, emergency call, floor indicating and local advertisement update and remote distributing.
13	Duplex color light for car button	Ensure duplex color display in car; white for standby, blue or red for response.

Standard function		
function	description	
14	Wireless 5-terminal intercom (FM)	between machine room and monitoring center, intercom between monitoring center and elevators be realized directly by digital technology
15	Digital video monitoring	Connect high-definition digital camera to interface RJ45 of monitoring center, realizing rapid transporting for monitoring data through network transmission, which obviously improves car monitoring result, receiving rapid response and showing more clearly pictures.
16	Emergency electric brake release while power off	Actuated by Backup battery, elevator moves slowly to door area, realizing quick and easy rescue function (Seal star contactor shall be equipped).
17	IC card system (basic type)	The system detects the running state of the elevator in real time. If the elevator speed exceeds the limit, the system immediately stops running of the elevator.
18	Hierarchical control IC card system	Hierarchical control function be applied in car, button light up after swiping IC card, then car moves to designated floor, One-Card, multi-floor control, Ray-per-view, networking and fire-fighting linkage functions can be realized. (Password keyboard, fingerprint identification and visitors linkage functions can be applied as option).
19	Time and number limited IC card system	Enter into car and get to any of the floors by wiping IC card, no hierarchical control; Pay-per-view, networking and fire-fighting linkage functions can be realized. (Password keyboard, fingerprint identification and visitors linkage functions can be applied as option).
20	Machine roomless leveling light	Machine roomless manual brake releasing, the car moves to the leveling position, the indicator light of leveling works to indicate the car be in leveling floor
21	Door open holding	In automatic running state, passengers can press the door open button in the car to delay door close in order to move in and out goods.
22	Forced door close	After active the force door close function, when the door fails to close within the set time due to the action of the light curtain or safety edge, the elevator enters the forced door close state, closes the door slowly, and gives a prompt tone.
23	Electronic remote butler (2G)	Based on the Electronic remote butler of MARGA Elevator Co., Ltd, the user can view the floor position, running direction and fault state of the elevator by using the IE clients, receive the remind incidents, maintenance expiration by using the movable terminal or clients. (Including three years of flow costs).

DUMBWAITER ELEVATOR

CONSTRUCTION LAYOUT DRAWING

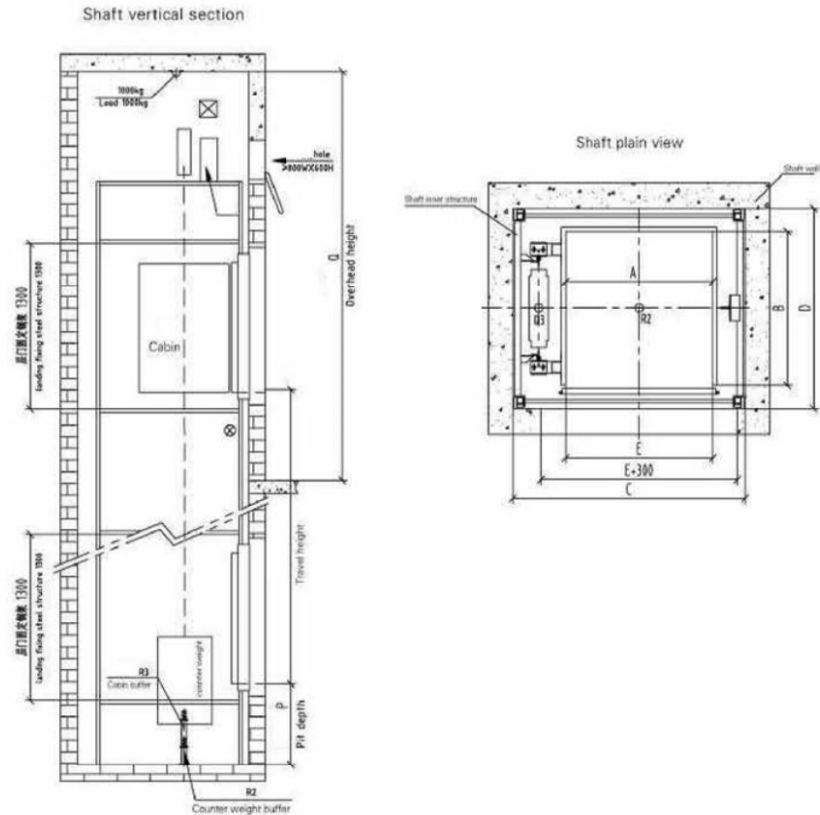

The Main Specification of Dumbwaiter

Model	Rated carrying	Rated speed	Cabin size (Wide A x depth B) (mm)	Door open width (mm)	Shaft size (width C x depth D) (mm)	Pit depth (mm)	Overhead height (mm)	Force (KN)		
	(kg)	(m/s)						R1	R2	R3
TW100/Q,4	100	0.4	800x800	800	1350x1100	750	3500	9	5	18
TW200/Q,4	200	0.4	800x1000	800	1350x1300	750	3500	11	7	22
TW250/Q,4	250	0.4	1080x1000	1000	1550x1300	750	3500	12	8	24

MACHINE ROOMLESS PASSENGER ELEVATOR CONSTRUCTION LAYOUT DRAWING

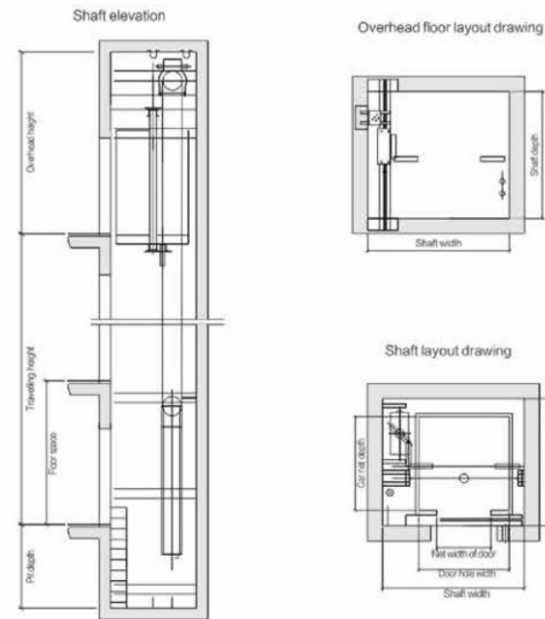

Machine roomless passenger specifications

Persons	Rated capacity (kg)	Rated speed (m/s)	Net size of car (mm)	Net size of door D,W x D,H (mm)	Shaft size (mm)			
			C,W x C,D x D,H	2P Central opening	H,W x H,D	HLH	PIT	
6	450	1.0	1100x1100x2300	800x2100	2050x1850	4200	1500	
		1.5/1.75	1400x1100x2300	800x2100	2250x1900	4200	1500	
8	630	1.0	1400x1350x2300	800x2100	2250x1950	4400	1600	
		1.5/1.75				4200	1500	
		2.0				4400	1600	
		2.5				4800	1800	
10	800	1.0				4800	1800	
		1.5/1.75				4800	2000	
		2.0				4800	2000	
		2.5				5100	2000	
13	1000	1.0	1500x1550x2300	900x2100	2350x2150	4500	1500	
		1.5/1.75				4700	1600	
		2.0				4900	1800	
		2.5				5100	2000	
21	1600	1.0	1900x1800x2300	1100x2100	2850x2400	4500	1500	
		1.5/1.75				4700	1600	
		2.0				4900	1800	
		2.5				5100	2000	
26	2000	1.0	1900x2200x2300	1100x2100	2900x2600	4500	1500	
		1.5/1.75				4700	1600	
		2.0				4900	1800	

Note: Only for reference, final manufacture please follow contract.

Marga Construction Layout Drawing



SMALL MACHINE ROOM PASSENGER ELEVATOR CONSTRUCTION LAYOUT DRAWING

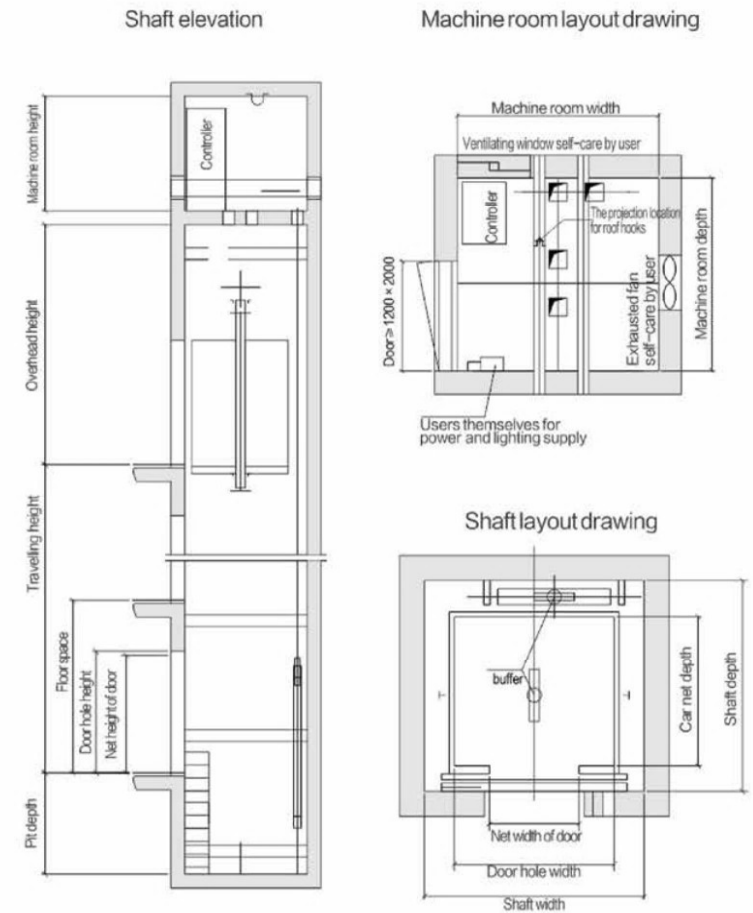

Small machine room passenger specifications

Persons	Rated capacity (kg)	Rated speed (m/s)	Net size of car (mm)	Net size of door D.W x D.H (mm)	Shaft size (mm)			Machine room size (mm)	
			G.W x C.D x D.H	2P Central opening	H.W x H.D	HR.H	P.T	MR.W x MR.D	MR.H
6	450	1.0	1400x850x2300	800x2100	2000x1800	4000	1500	2000x1800	2500
8	630	1.0	1400x1100x2300	800x2100	2000x2050	4200	1500	2000x2050	2500
10	800	1.0	1400x1350x2300	800x2100	2000x2300	4200	1500	2000x2300	2500
13	1000 (1050)	1.5/1.75	1600x1450x2300	900x2100	2200x2400	4400	1600	2200x2400	2500
		2.0	1100x2300x2300 (Residence / stretcher elevator)		2050x2850 (Residence / stretcher elevator)	4800	1800	2050x2850 (Residence / stretcher elevator)	
		2.5				5200	2600		
		3.0				5500	3100		
		3.5				6000	3850		
		4.0				6000	3850		
16	1250	1.0	1900x1450x2300	1100x2100	2500x2400	4200	1500	2500x2400	2500
		1.5/1.75				4400	1600		
		2.0				4800	1800		
		2.5				5200	2000		
		3.0				5200	2600		
		3.5				5500	3100		
		4.0				6000	3850		
18	1350	1.0	1900x1550x2300	1100x2100	2500x2500	4200	1500	2500x2500	2500
		1.5/1.75				4500	1600		
		2.0				4800	1800		
		2.5				5200	2000		
		3.0				5200	2600		
		3.5				5500	3100		
		4.0				6000	3850		
21	1600	1.0	1900x1800x2300	1100x2100	2500x2800	4200	1500	2500x2800	2500
		1.5/1.75				4500	1600		
		2.0				4800	1800		
		2.5				5200	2000		
		3.0				5200	2600		
		3.5				5500	3100		
		4.0				6000	4000		
26	2000	1.0	1900x1800x2800	1100x2100	2700x2900	6350	5000	4200x2900	2500
		1.5/1.75	1900x2200x2300	1100x2100	2800x3000	8800	7200	4300x3000	3800
		2.0				4500	1500	2700x2800	2500
		2.5				4700	1600		
		3.0				5000	1800		
		3.5				6000	3850		
		4.0				6400	4000		
		8.0	1900x2200x2800	1100x2100	3200x3000	7500	6000	4700x3300	3800
		10.0				8800	7200		

Note: Only for reference, final manufacture please follow contract.

SEMICIRCLE OBSERVATION ELEVATOR CONSTRUCTION LAYOUT DRAWING

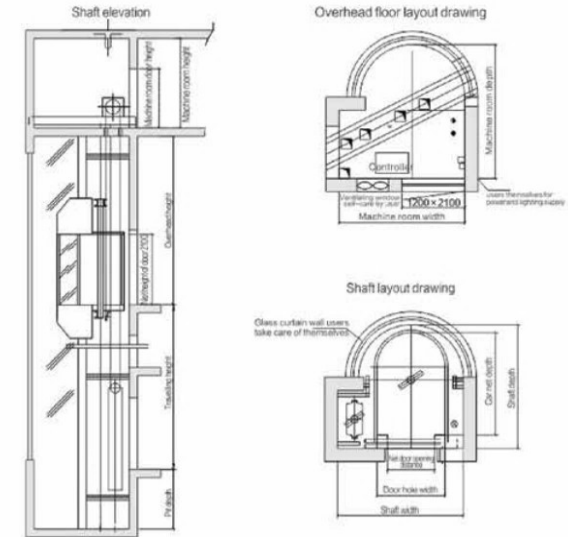

Semicircle machine room / Machine roomless elevator specifications

Persons	Rated capacity (kg)	Rated speed (m/s)	Net size of car (mm)	Net size of door (mm)	Shaft size (mm)			Machine room size (mm)	
			C.W x C.D x D.H	2P Central opening	H.W x H.D	HR.H	P.T	MR.W x MR.D	MR.H
8	630	1.0	1100x1600x2300	700x2100	2200x2185	4500	1500	2200x2185	2500
		1.5/1.75				4700	1600		
10	800	1.0	1200x1800x2300	800x2100	2300x2365	4800	1500	2300x2365	2500
		1.5/1.75				4700	1600		
		2.0				4900	1800		
		2.5				5100	2000		
13	1000	1.0	1300x1950x2300	900x2100	2400x2535	4500	1500	2400x2535	2500
		1.5/1.75				4700	1600		
		2.0				4900	1800		
		2.5				5100	2000		
16	1250	1.0	1400x2150x2300	900x2100	2500x2600	4500	1500	2500x2600	2500
		1.5/1.75				4700	1600		
		2.0				4900	1800		
		2.5				5100	2000		
18	1350	1.0	1500x2150x2300	1000x2100	2500x2600	4500	1500	2500x2600	2500
		1.5/1.75				4700	1600		
		2.0				4900	1800		
		2.5				5100	2000		
21	1600	1.0	1500x2450x2300	1000x2100	2600x2900	4500	1500	2500x2900	2500
		1.5/1.75				4700	1600		
		2.0				4900	1800		
		2.5				5100	2000		
		3.0				5200	2600		
		3.5				5500	3850		
		4.0				6000	4000		
26	2000	1.0	1700x2600x2300	1100x2100	2800x3050	4700	1600	2800x3050	2500
		1.5/1.75				4900	1800		
		2.0				5200	2600		
		2.5				5500	3850		
		3.0				6000	4000		
		4.0				6000	3850		

Note: Only for reference, final manufacture please follow contract.

SQUARE OBSERVATION

ELEVATOR CONSTRUCTION LAYOUT DRAWING

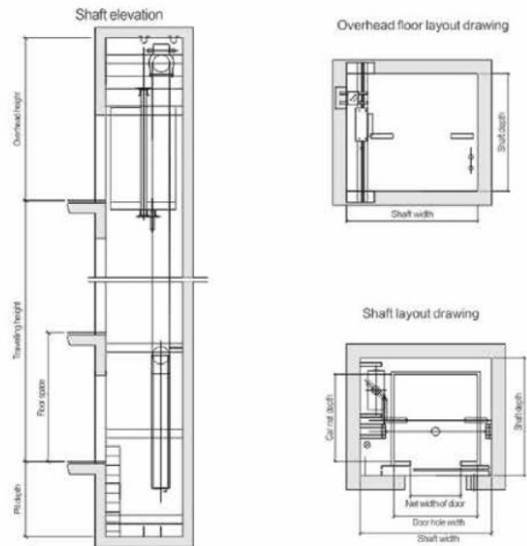

Square machine room / Machine roomless elevator specifications

Persons	Rated capacity (kg)	Rated speed (m/s)	Net size of car (mm)	Net size of door D.W x C.H (mm)	Shaft size (mm)			Machine room size (mm)	
			C.W x C.D x D.H	2P Central opening	H.W x H.D	HLRH	PIT	MLR.W x MLR.D	MLRH
6	450	1.0	1100x1100x2300	800x2100	2050x1850	4200	1500		
8	630	1.0	1400x1100x2300	800x2100	2250x1900	4200	1500	/	/
		1.5/1.75				4400	1600		
		1.0				4200	1500		
10	800	1.5/1.75	1400x1350x2300	800x2100	2250x1950	4400	1600	/	/
		2.0				4800	1800		
		2.5					2000		
		1.0				4200	1500		
13	1000	1.5/1.75	1500x1550x2300	900x2100	2350x2150	4400	1600	/	/
		2.0				4800	1800		
		2.5				4800	2000		
		1.0				4500	1500		
21	1600	1.5/1.75	1900x1800x2300	1100x2100	2850x2400	4700	1600	/	/
		2.0				4900	1800		
		2.5				5100	2000		
		3.0	1500x2450x2300	1100x2100	2600x2900	5200	2600	2600x2900	2500
		4.0	1900x1800x2800	1100x2100	3150x2400	6000	4900	3150x2400	2800
26	2000	1.0				4500	1500		
		1.5/1.75	1900x2200x2300	1100x2100	2500x2600	4700	1600	/	/
		2.0				4900	1800		
		3.0	1700x2600x2300	1100x2100	2800x3050	5200	2600	2800x3050	2500
		4.0	1900x2200x2800	1100x2100	3150x2700	6000	4900	3150x2700	2800

Note: Only for reference, final manufacture please follow contract.



VILLA ELEVATOR

CONSTRUCTION LAYOUT DRAWING

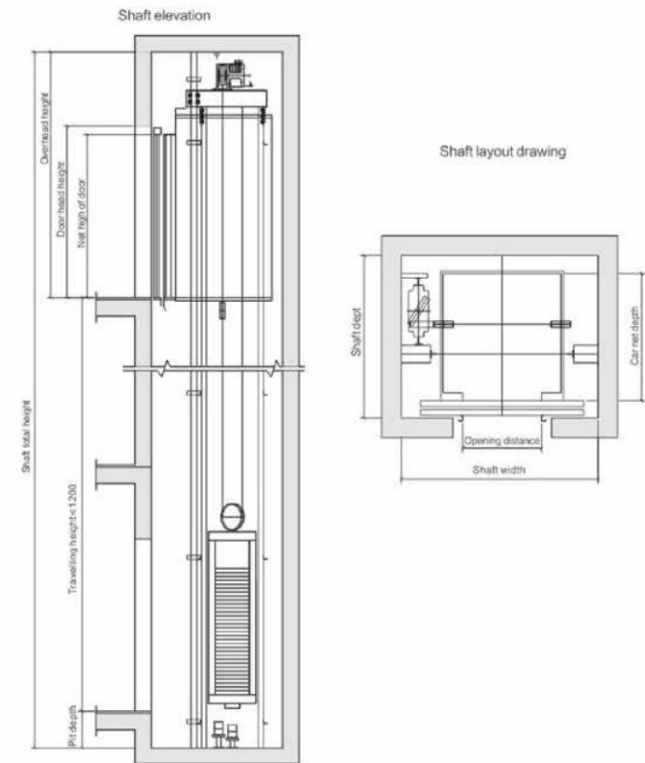

Villa elevator specifications

Persons	Rated capacity (kg)	Rated speed (m/s)	Net size of car (mm)	Net size of door D.W x C.H (mm)	Shaft size (mm)		
			C.W x C.D x D.H	2P Central opening	H.W x H.D	HLRH	PIT
3	260	0.4	800x1150x2200	700x2000 Side door	1400x1500	3500	800
4	320	0.4	950x1300x2200	700x2000	1600x1600	3500	800
5	400	0.4	1200x1300x2200	800x2000	1850x1600	3500	800

Note: Only for reference, final manufacture please follow contract.



Marga Construction Layout Drawing

HOSPITAL ELEVATOR

CONSTRUCTION LAYOUT DRAWING

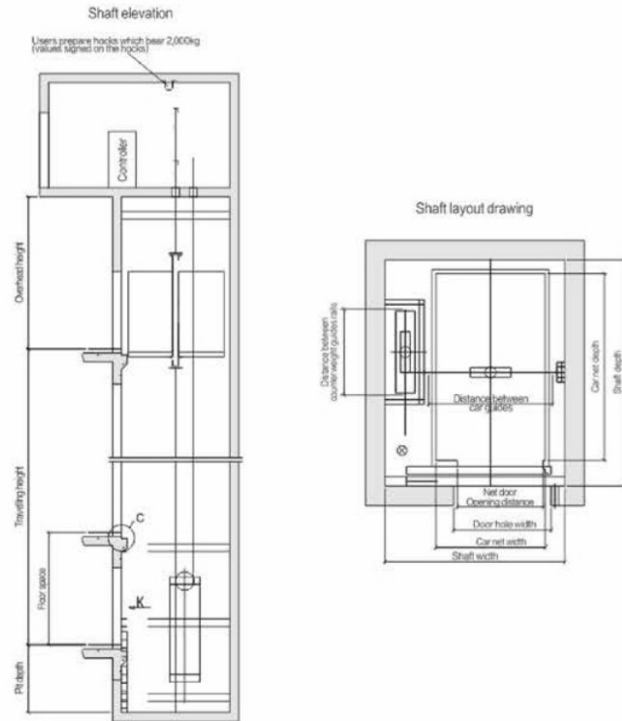

Machine room / Machine roomless hospital elevator specifications

Persons	Rated capacity (kg)	Rated speed (m/s)	Net size of car (mm)	Net size of door (mm)	Shaft size (mm)			Machine room size (mm)	
			C.W x C.D x D.H	D.W x D.H	H.W x H.D	H.R.H	PIT	M.R.W x M.R.D	M.R.H
21	1600	1.0	1400x2400x2300	1100x2100	2550x2900	4500	1500	2550x2900	2500
		1.5/1.75				4700	1600		
		2.0				4900	1800		
		2.5				5100	2000		
		3.0				5300	2200		
24	1800	1.0	1600x2400x2300	1200x2100	2750x2900	4500	1500	2750x2900	2500
		1.5/1.75				4700	1600		
		2.0				4900	1800		
		2.5				5100	2000		
		3.0				5300	2200		
26	2000	1.0	1700x2400x2300	1200x2100	2850x2900	4500	1500	2850x2900	2500
		1.5/1.75				4700	1600		
		2.0				4900	1800		
		2.5				5100	2000		
		3.0				5300	2200		

Note: Only for reference, final manufacture please follow contract.



Marga Construction Layout Drawing

FREIGHT ELEVATOR

CONSTRUCTION LAYOUT DRAWING

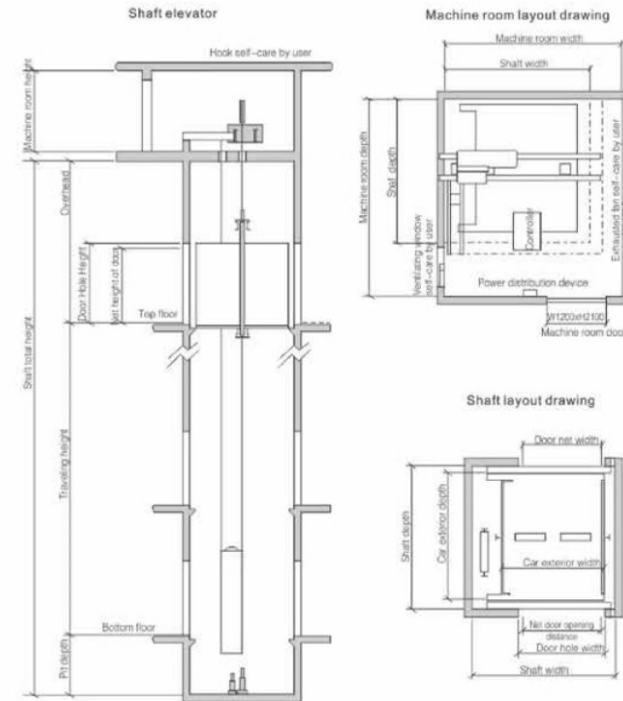

Freight elevator specifications

Load (kg)	Speed (m/s)	Exterior size of car width x depth x height (mm)	Net door opening width x height (mm)	Shaft Net Size			Machine Room Net Size		Door Open type
				width x depth (mm)	Overhead height (mm)	Pit depth (mm)	width x depth (mm)	height (mm)	
630	0.5	1200x1500x2200	1100x2100	2100x1860	4200	1500	2500x3000	2200	Two panel side opening
1000	0.5	1500x1800x2200	1200x2100	2250x2160	4200	1500	3000x3000	2200	Two panel side opening
2000	0.5	1570x2900x2200	1500x2100	2700x3260	4200	1500	3500x3000	2500	Two panel side opening
	1.0				4500	1500			
	1.5				4500	1500			
	2.0				4500	1600			
	2.5				4800	1800			
3000	0.25	2070x3050x2200	1800x2100	3300x3410	4500	1500	3800x4200	2500	Four panel center opening
3200	1.0	2070x3100x2200	1800x2100	3300x3460	4500	1500	3800x4200	2500	Four panel center opening
5000	0.25	2800x3400x2500	2000x2200	4200x3800	5000	1600	4200x3800	2800	Four panel center opening
7000	0.25	3000x4200x2500	2600x2400	4500x4600	5000	1600	4500x4600	2800	Four panel center opening
10000	0.25	3070x5760x2500	2600x2400	4900x6200	5000	1600	4900x6200	2800	Four panel center opening

Note: Only for reference, final manufacture please follow contract.



MACHIN ROOMLESS (MRL) FREIGHT ELEVATOR CONSTRUCTION LAYOUT DRAWING

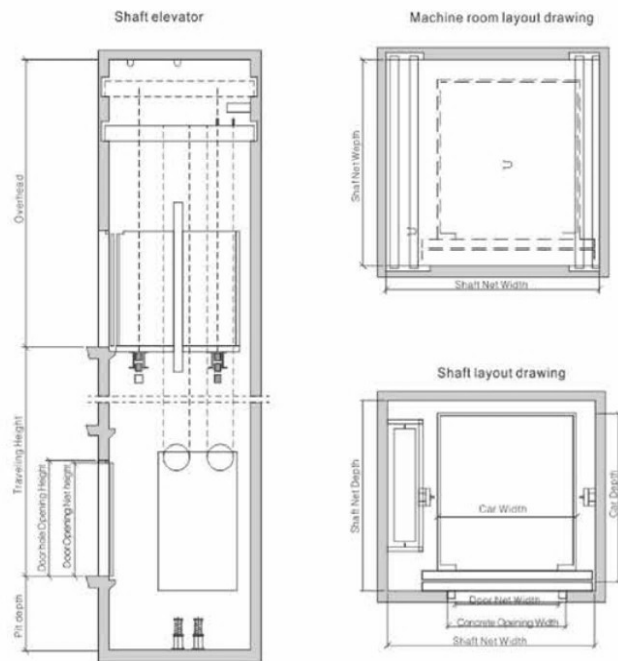

Machine roomless(MRL) freight elevator specifications

Load (kg)	Speed (m/s)	Exterior size of car width x depth x height (mm)	Net door opening width x height (mm)	Shaft Net Size			Door Open type
				width x depth (mm)	Overhead height	Pit depth	
1000	0.5	1500x1800x2200	1200x2100	2250x2200	4500	1500	Two panel side opening
	1.0				4500	1500	
	1.5				4600	1600	
	2.0				4800	1800	
2000	0.5	2000x2300x2200	1500x2100	3150x2660	4800	1500	Two panel side opening
	1.0				5000	1500	
	1.5				5200	1600	
	2.0				5200	1800	
3000	0.5	2470x2560x2200	1800x2100	3700x3000	5000	1600	Four panel center opening
5000	0.5	2800x3400x2500	2400x2400	4250x3800	6100	1600	Four panel center opening

Note: Only for reference, final manufacture please follow contract.



Marga Construction Layout Drawing



STRATEGIC ARRANGEMENT OF MARKTING



R1 NO 2 ERATUS STREET
KIPSELI, ATHENS, GREECE
athens@margalift.com
0030694627668
0030694627668



R1201 F12 B2 TIME CENTER
QIUTAON, HANGZHOU, CHINA
admin@margalift.com
008657186483272
008613071802370



NEXT TO KIA CO AL MUTHANA
AIRPORT ST, BAGHDAD, IRAQ
baghdad@margalift.com
00964771000671
00964781000671



Hangzhou Margalift Trading Co. Ltd.

was established at 2014 to provide quality products in a timely manner located in the center of national famous tourist city Hangzhou and near to the west lake. The company has been engaged in overall elevator & escalator and their accessories (including guide rail, steel wire rope, elevator light curtain, traction machine, elevator safety components, such as driving wheel, chain, etc.) related to import and export business. The major markets involving the Middle East and Europe countries.

Over the years, our company has been engaged in the import and export of escalators and their accessories, and has accumulated many foreign customers to understand the needs of foreign markets. Moreover,

we have our own website for external display and sales: www.margalift.com which can help you sell and buy products abroad.

We can provide you any product, which is belonged to elevator and escalator if you need and we can prepare the good quality products with suitable prices. Looking for you to Work Together.

If you are interested, we would be happy to provide you with more details.
EMAIL: admin@margalift.com



R1201 F12 B2 TIME CENTER
QIUTAON, HANGZHOU, CHINA
admin@margalift.com
008657186483272
008613071802370



NEXT TO KIA CO AL MUTHANA
AIRPORT ST, BAGHDAD, IRAQ
baghdad@margalift.com
00964771000671
00964781000671



R1 NO 2 ERATUS STREET
KIPSELI, ATHENS, GREECE
athens@margalift.com
0030694627668
0030694627668